



L SHAPE | ROAD BARRIER | BLOCK DRAIN (JKR SPEC)

Precast Concrete Product



TIAN FUNG
TRADING SDN BHD
Sirim Certified MS 1293 : PT.1 : 1992



L SHAPE

Features

TIAN FUNG [SVC] L-Shape unit standard length is in 1000mm, but it is also available in various height, width or length and can be designed to suit the site conditions and fulfil the project requirements.

Application

- 1 Retaining Wall
- 2 Open Drain
- 3 Storage Wall
- 4 Fence Wall & etc

Advantages

Precast L-Shape units has the following advantages over cast in-situ structures:

- 1 Easily assembled or dismantled for service elsewhere
- 2 Reliable factory cast concrete
- 3 Maintenance eliminated
- 4 Can be off loaded from transport and erected in one operation

Design Consideration

- 1 TIAN FUNG [SVC] L-Shape unit is designed in accordance with the requirement of BS 8110 with the minimum concrete cover to reinforcement = 25mm.
- 2 TIAN FUNG [SVC] L-Shape unit are made from high strength concrete with a 28 days characteristic strength from 35 to 40 N/mm²
- 3 Soil parameters used:
 - (i) Bulk density compacted backfill = 19kN/ m³
 - (ii) Angle of internal friction = 30°
 - (iii) Coefficient of active earth pressure = 0.333
- 4 Hydrostatic pressure is eliminated by provision of 50mm diameter weepholes placed along the wall.
- 5 The backfill material adjacent to the wall should be granular type of soil.
- 6 TIAN FUNG [SVC] L-Shape unit standard design is catered for a maximum height of 150mm in-situ capping.
- 7 For other loading conditions and sizes requirement, kindly provide the information and contact our Technical Personnel for assistance.

Stacking

All units should be stacked uniformly on levelled ground.

Jointing

TIAN FUNG [SVC] L-Shape unit is supplied with plain butt joints in 1.0 metre standard length. Cement mortar is normally used to fill the gap between the units.

Laying

TIAN FUNG [SVC] L-Shape unit should be laid on the prepared bedding (preferable compacted sand bedding). However, in bad ground condition, it may be necessary to replace with suitable soil or provide with piled foundation (by others) which is subjected to the engineer's (or s.o) specification and details.

L SHAPE DRAIN SYSTEM

Loading Conditions: Type 1 & 2

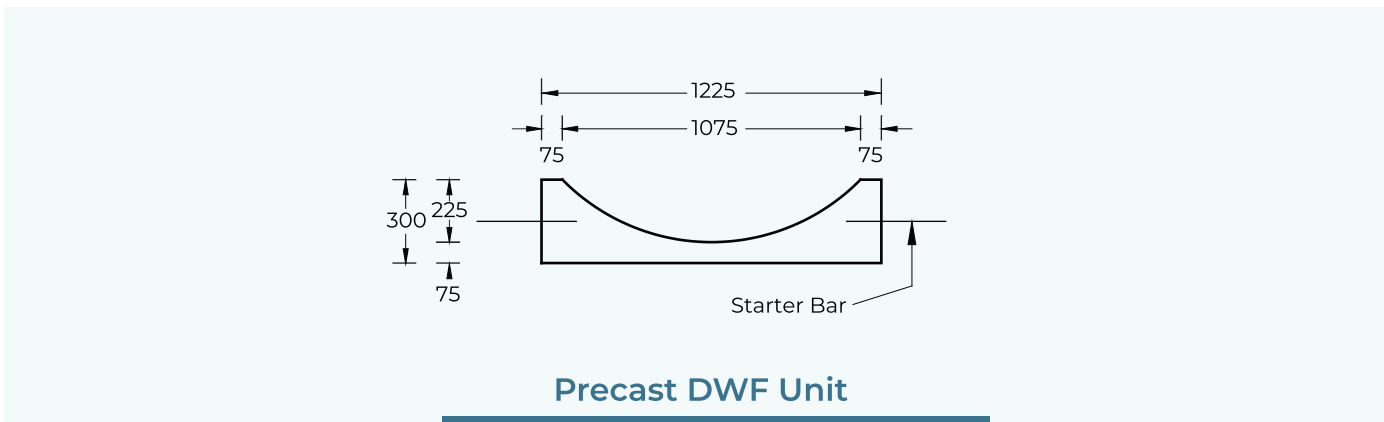
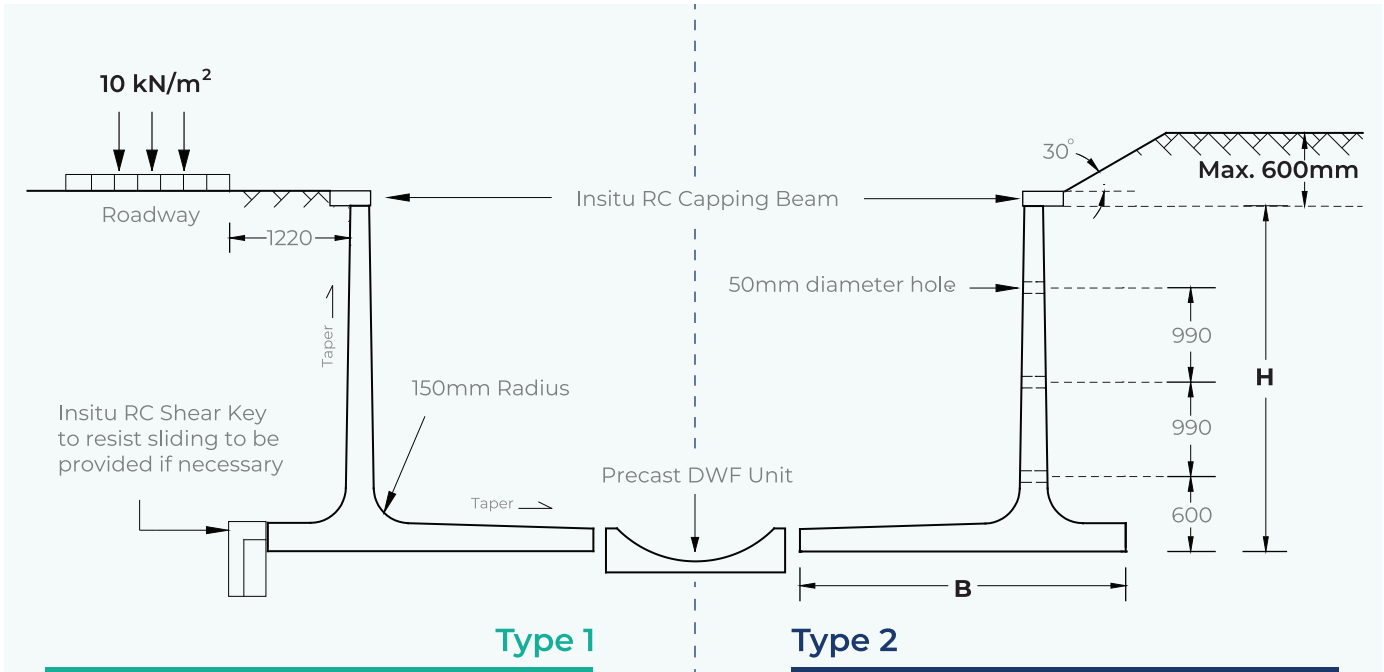

Height (H) mm	Type 1 Loading		Type 2 Loading	
	Length (B) mm	Weight tonnes	Length (B) mm	Weight tonnes
915	1080	0.79	1080	0.79
1220	1250	0.90	1080	0.90
1520	1420	1.11	1380	1.11
1830	1690	1.31	1690	1.31
2130	1990	1.50	1990	1.50
2440	2300	1.69	2300	1.69
2740	2600	1.87	2600	1.87
3050	2910	2.04	2910	2.04
3350	3210	2.21	3310	2.24
3660	3520	2.38	3770	2.46

L SHAPE RETAINING WALL

Loading Conditions: Type 3 (a) & 3 (b)

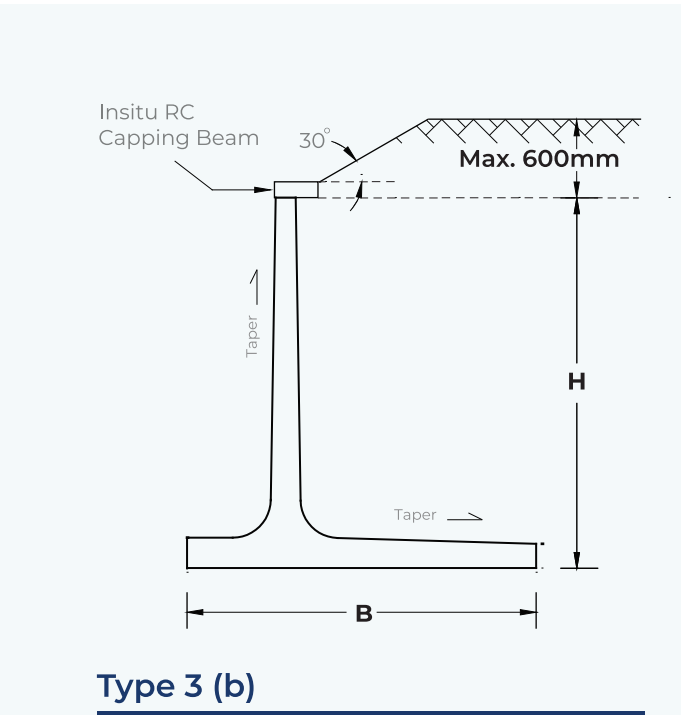
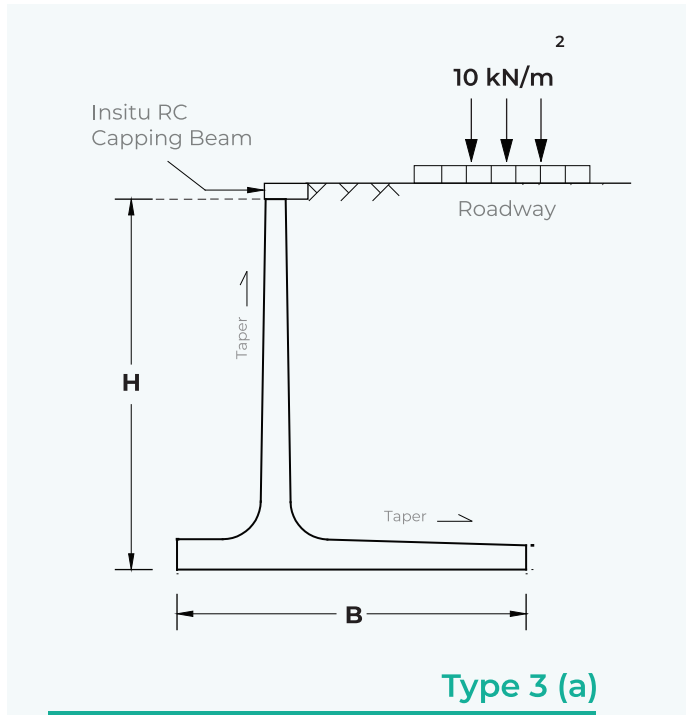

Type 3 (a) & (b) Loading		
Height (H) mm	Length (B) mm	Weight tonnes
915	1050	0.76
1220	1190	0.94
1520	1370	1.10
1830	1555	1.26
2130	1735	1.42
2440	1920	1.57
2740	2100	1.73
3050	2225	1.85
3350	2410	1.99
3660	2590	2.11



ROAD BARRIER

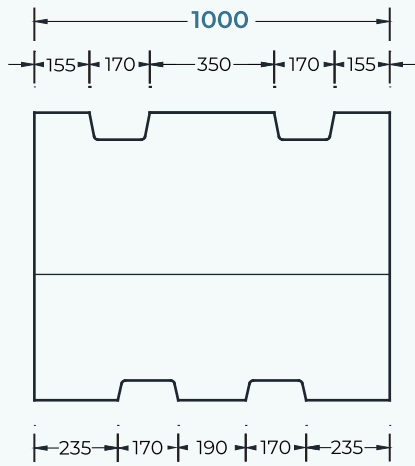

Front view

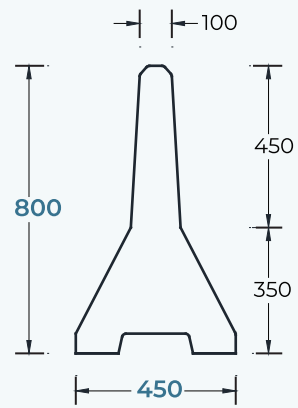

Side view

Available Size (mm)

W x H	Length
450 x 800	1,000 (1 meter)



JKR SPEC BLOCK DRAIN

SAVE
TIME, EFFORT & COST

BRAND NEW DESIGN FEATURES:

- ✓ LENGTH UP TO 1200 MM / 3.9 FEET PER UNIT
- ✓ 2 x FASTER UNLOADING TIME
- ✓ 3 x FASTER INSTALLATION TIME
- ✓ LONG LASTING

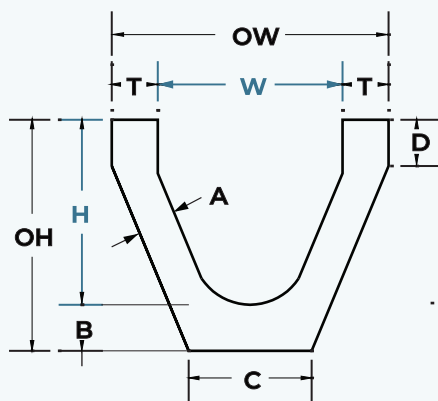

Front view

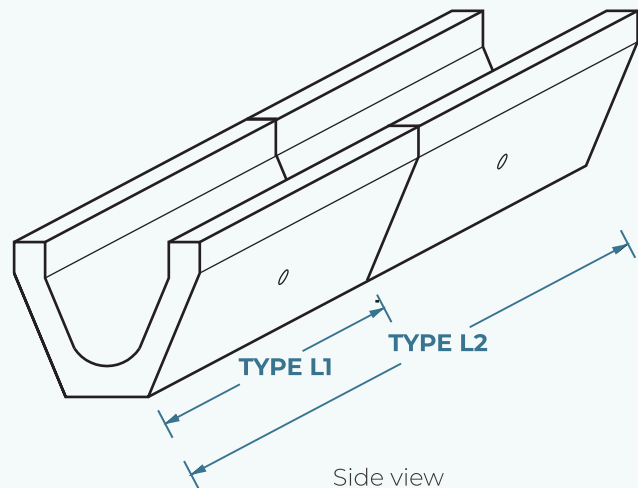

Side view

Nominal Size			Dimension Detail							TYPE L1		TYPE L2	
W	x	H	T	OW	OH	A	B	C	D	Length	Weight	Length	Weight
mm	mm	mm (inch)	mm	mm	mm	mm	mm	mm	mm	mm	kg	mm	kg
300	x	300 (12")	75	450	375	70	75	200	75	600	84	1200	168
375	x	375 (15")	75	525	455	75	80	250	75	600	120	1200	240
450	x	450 (18")	75	600	530	75	80	305	150	600	150	1200	300
600	x	600 (24")	75	750	690	85	90	405	150	600	215	1200	430

**For special requirement or Block Drain size not shown in the tables, kindly contact our Technical Personnel for assistance.

JKR SPEC BLOCK DRAIN

Specification & Reinforcement Details

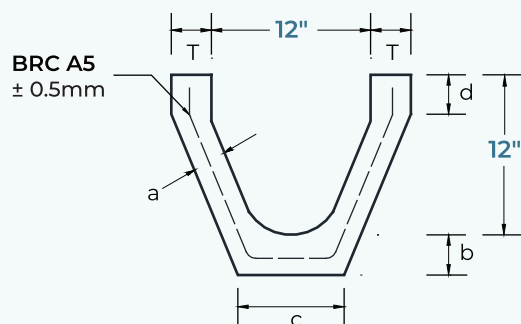

- T: 75mm
- a: 70mm
- b: 75mm
- c: 200mm
- d: 75mm

Length: 600mm/1200mm

300mm / 12" JKR Block Drain

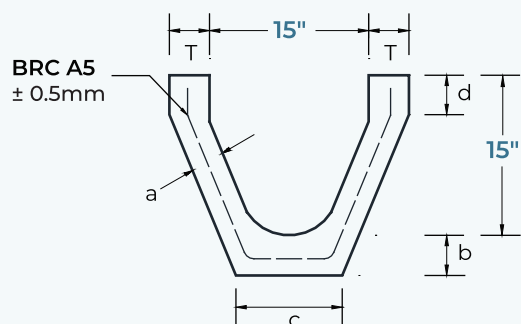

- T: 75mm
- a: 75mm
- b: 80mm
- c: 250mm
- d: 75mm

Length: 600mm/1200mm

375mm / 15" JKR Block Drain

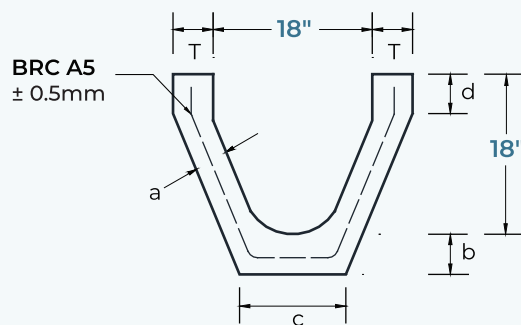

- T: 75mm
- a: 75mm
- b: 80mm
- c: 305mm
- d: 150mm

Length: 600mm/1200mm

450mm / 18" JKR Block Drain

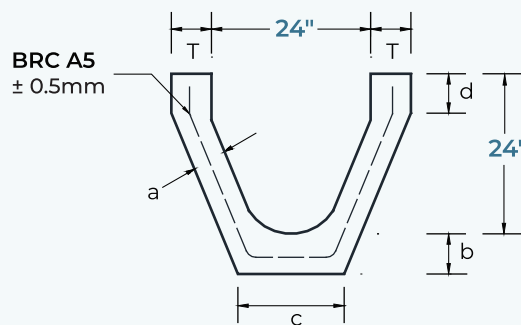

- T: 75mm
- a: 85mm
- b: 90mm
- c: 405mm
- d: 150mm

Length: 600mm/1200mm

600mm / 24" JKR Block Drain

Note: Concrete characteristic strength at 28 days for product above is 30 ± 5 MPa



TIAN FUNG TRADING SDN BHD 706369-T

Site Address Lot 326 Off Batu 4, Jln Kg. Sepang Ke Sg. Pelek, 43950 Sg. Pelek, Selangor

Email Address enquiry@tianfung.com / tianfungtrading@gmail.com

Website www.tianfung.com

Hp 016- 228 9512 (Whatsapp Line)

Tel 03- 3142 1512

Fax 03- 3141 3859